

HEXPRO[®] SERIES

LOW PROFILE TORQUE WRENCHES

HEXPRO Series Low Profile Wrenches are essential tools for limited clearance applications. The versatile HEXPRO Series supports an extensive range of interchangeable hexagon ratchet links which deliver a torque range of 162 ft-lbs. to 28,861 ft-lbs. (220 Nm to 39,130 Nm).



HEXPRO 4HP

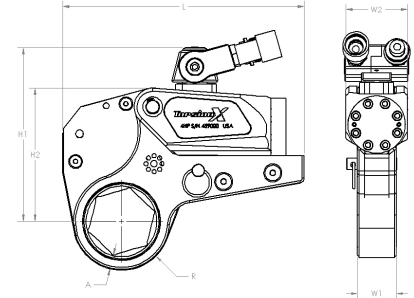

HEXPRO 4HP-B

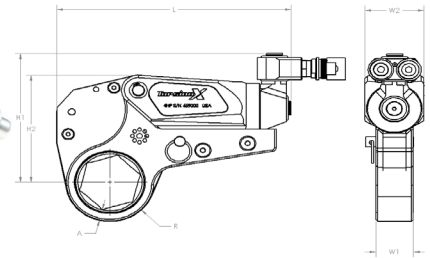

HEXPRO 4HP-HD

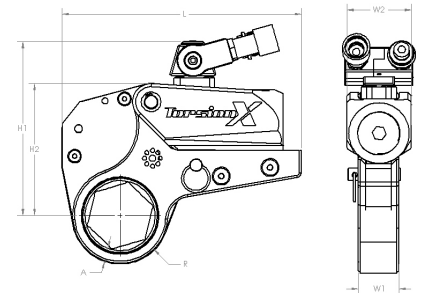

HEXPRO SPECIFICATIONS

Model	4HP-HD	
Torque (ft-lbs.)	409-4,369	
Torque (Nm)	554-5,923	
Hex Size (Imperial)	1.5/16" - 3.1/8"	
Hex Size (Metric)	36 mm - 80 mm	
Power Head	5 lbs	12.27 kg
Ratchet Link	9 lbs	4.09 kg
L	9.72"	246.9 mm
H1	7.44"	178.8 mm
H2	5.71"	145.0 mm
W1	1.65"	41.9 mm
W2	2.60"	66.0 mm
A	.58"	14.7 mm
R	1.397"-2.393"	35.5mm - 60.8mm

Model	2HP/2HP-B		4HP/4HP-B		8HP		14HP		30HP	
Torque (ft-lbs.)	162 - 1,714		439 - 4,500		762 - 8,100		1,245 - 13,443		2,846 - 28,861	
Torque (Nm)	220 - 2,324		595 - 6,101		1,033 - 10,982		1,689 - 18,229		3,858 - 39,130	
Hex Size (Imperial)	3/4" - 2.3/8"		1.5/16" - 3.1/8"		1.1/2" - 3.15/16"		2" - 4.5/8"		3.1/8" - 6.7/8"	
Hex Size (Metric)	19 mm - 60 mm		36 mm - 80 mm		41 mm - 100 mm		50 mm - 115 mm		80 mm - 175 mm	
Power Head	3 lbs	1.36 kg	5 lbs	2.27 kg	8 lbs	3.63 kg	13 lbs	5.90 kg	27 lbs	12.27 kg
Ratchet Link	4 lbs	1.81 kg	9 lbs	4.09 kg	16 lbs	7.27 kg	26 lbs	11.82 kg	70 lbs	31.82 kg
L	7.32"/7.70"	185.9mm/195.9mm	9.72"/10.31"	246.9mm/261.8mm	11.87"	301.5 mm	14.24"	361.7 mm	17.05"	433.1 mm
H1	5.26"/5.05"	133.6mm/128.2mm	7.36"/6.42"	186.9mm/163.0mm	8.43"	214.1 mm	9.41"	239.0 mm	12.40"	315.0 mm
H2	4.12"/4.12"	104.7mm/104.7mm	5.71"/5.71"	145.0mm/145.0mm	6.95"	176.5 mm	8.00"	203.2 mm	11.22"	285.0 mm
W1	1.25"/1.25"	31.8mm/31.8mm	1.65"/1.65"	41.9mm/41.9mm	2.08"	52.8 mm	2.52"	64.0 mm	3.35"	85.1 mm
W2	2.00"/2.00"	50.8mm/50.8mm	2.60"/2.60"	66.0mm/66.0mm	3.27"	83.1 mm	3.88"	98.6 mm	5.16"	131.1 mm
A	.390"/.390"	9.9mm/9.9mm	.580"/.580"	14.7mm/14.7mm	.650"	16.5 mm	.740"	18.8 mm	1.010"	25.7 mm
R	1.054"-1.766"	26.8mm - 44.9mm	1.397"- 2.393"	35.5mm-60.8mm	1.882"-2.944"	46.3mm-74.8mm	2.340"-3.416"	59.4mm-86.8mm	3.037"-4.559"	77.1mm-115.8mm



For more information call

+1.304.744.9489